



Sistema / System

# › COR VISION

SISTEMAS DE ALUMINIO Y PVC PARA LA ARQUITECTURA  
ARCHITECTURAL ALUMINIUM AND PVC SYSTEMS

Sistema / System  
**>COR VISION**

New PAS 24



**CERRAMIENTOS CONTEMPORÁNEOS**  
CONTEMPORARY ENCLOSURES



# COR VISION SLIDING SYSTEM

TBB

PAS 24:2022

## ENERGY EFFICIENCY

Thermal Transmission Coefficient

**$U_w$  from 1.3 (W/m<sup>2</sup>K)**

Please consult typology, dimensions and glazing

## ACCOUSTIC INSULATION

Maximum glazing: **30 mm.**

Maximum acoustic insulation: **Rw = 41 dB.**

## CATEGORIES ACHIEVED AT TEST CENTRE

Protection against atmospheric agents

Air permeability (EN 12207:2000):

Water tightness (EN 12208:2000):

Wind resistance (EN 12210:2000):

\* Reference test: Balcony 1.23 x 1.55 m, 1 sash + 1 fixed

**Class 4**

**Class 7A**

**Class C5**

**PAS 24:2022. APPROVED**

SECTIONS	Frame 116 mm Triple rail 182 mm Sash 37 mm
PROFILE THICKNESS	Door 1.7 mm
MAXIMUM DIMENSIONS	Width (L) = 2,500 mm Height (H) = 3,000 mm
MAXIMUM WEIGHT/SASH	320 Kg
DRAINAGE	Optionally drainage system and drainage grid made of stainless steel

Please consult regarding maximum weight and dimensions according to types

EXTRUSION ALLOY	6063 T-5
POLYAMIDE STRIP LENGTH	Polyamide 6.6 reinforced with 25% fiberglass from 16 to 24 mm
OPENING POSSIBILITIES	Sliding 2, 3, 4 and 6 sashes. Optionally monorail and triple rail (1 sash+1 fixed) (2 sashes+1 fixed). Optionally corner sash at 90° without mullions. Galandage 1 and 2 sashes

## FINISHES

Colour powder coating  
(RAL, mottled, rough...)

According to Qualicoat >60 micras

Wood effect powder coating

According to Qualideco standard

Anodized

According to Ewwa Euras  
Standard Class 15

Optionally Class 20 and 25

Optionally bicoloured

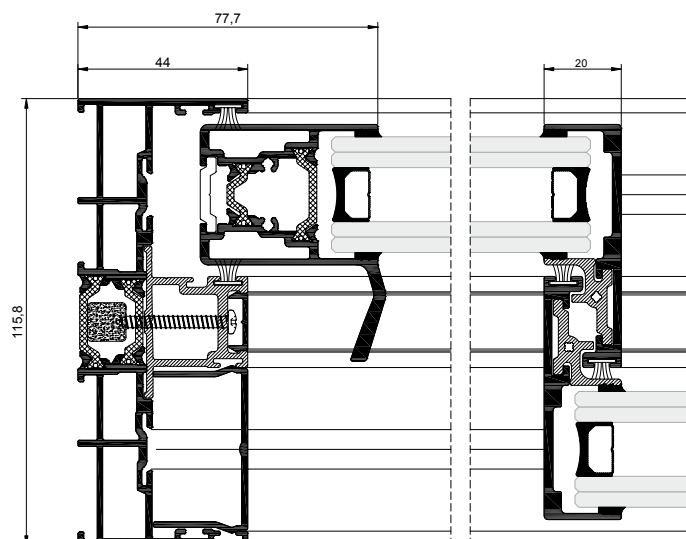

# PAS 24:2022

## Annex A&B



**Test of: COR VISION 2 pane aluminium sliding doorset**

**Enhanced security performance requirements for doorsets**

A Report To:  
Aluminios Cortizo  
Extramundi, Padr+ln, A Coru+ia

Document Reference:  
WIL 539748

**Date:** 06/02/2024

**Copy:** 1

**Issue No.:** 1

Page 1

## TEST CONCLUSIONS

Samples of:  
 Manufacturer Aluminios Cortizo  
 Product Doorset  
 Model COR VISION 2 pane aluminium sliding doorset

have been tested in accordance with: PAS24:2022 Annex A&B  
 By Element Materials Technology, a UKAS accredited Testing Laboratory (No. 0621)

At Unit 3 Wednesbury One, Black Country New Road, Wednesbury, WS10 7NZ.  
 Results and comments as detailed below:

Clause No.	Description	Compliance
<b>4</b>	<b>Enhanced security performance requirements</b>	*
<b>5</b>	<b>Marking</b>	*
<b>6</b>	<b>Design and general requirements</b>	*
<b>Annex A</b>	<b>Security hardware and cylinder test and assessment</b>	<b>N/A</b>
A.3	Test procedure	N/A
A.4	Cylinder vulnerability assessment	N/A
<b>Annex B</b>	<b>Enhanced security performance for doorsets</b>	<b>Yes</b>
B.4.3	Manipulation test	Yes
B.4.4.2	Infill manual test	Yes
B.4.4.3	Infill mechanical test	Yes
B.4.4.4	Manual cutting test	N/A
B.4.5	Mechanical loading test	Yes
B.4.6	Manual check test	Yes
B.4.7	Additional mechanical loading test	N/A
B.4.8	Soft body impact test	Yes
B.4.9	Hard body impact test	N/A

No inferences can be made regarding performance against other requirements of this standard

Test marked \* are not assessed by test

Tests marked N/A are not applicable to the sample under test.  
 Tests marked N/T were not applied to the sample under test

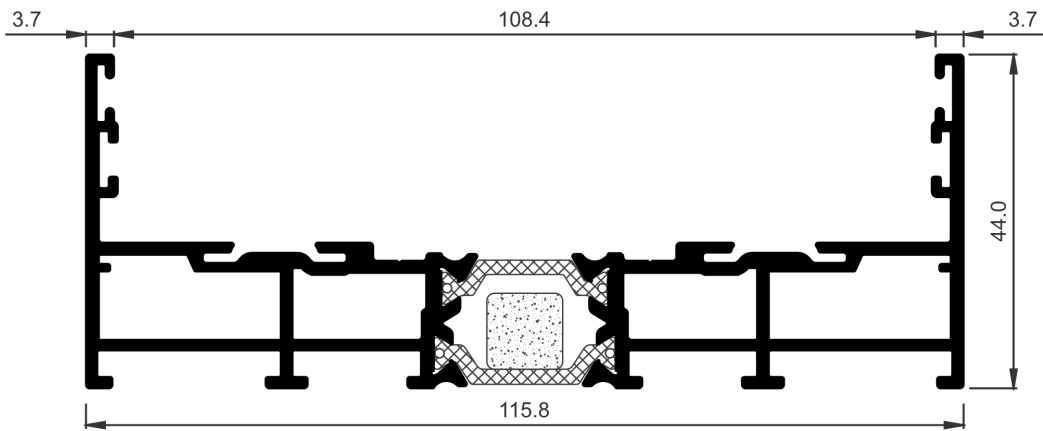

**COR-4389**

<b>Descripción</b> Description	Marco HI con carril inox. HI frame with stainless steel
<b>Peso</b> Weight (g/m)	2019,8
<b>Superficie</b> Surface (dm <sup>2</sup> /m)	83,12
<b>I<sub>x</sub></b> (cm <sup>4</sup> )	6,81
<b>I<sub>y</sub></b> (cm <sup>4</sup> )	106,26
<b>Escuadra principal</b> Main cleat	248220
<b>Troquel</b> Punch tool	304398
<b>Escuadra secundaria</b> Secondary cleat	248220
<b>Escuadra alineamiento</b> Alignment cleat	960023

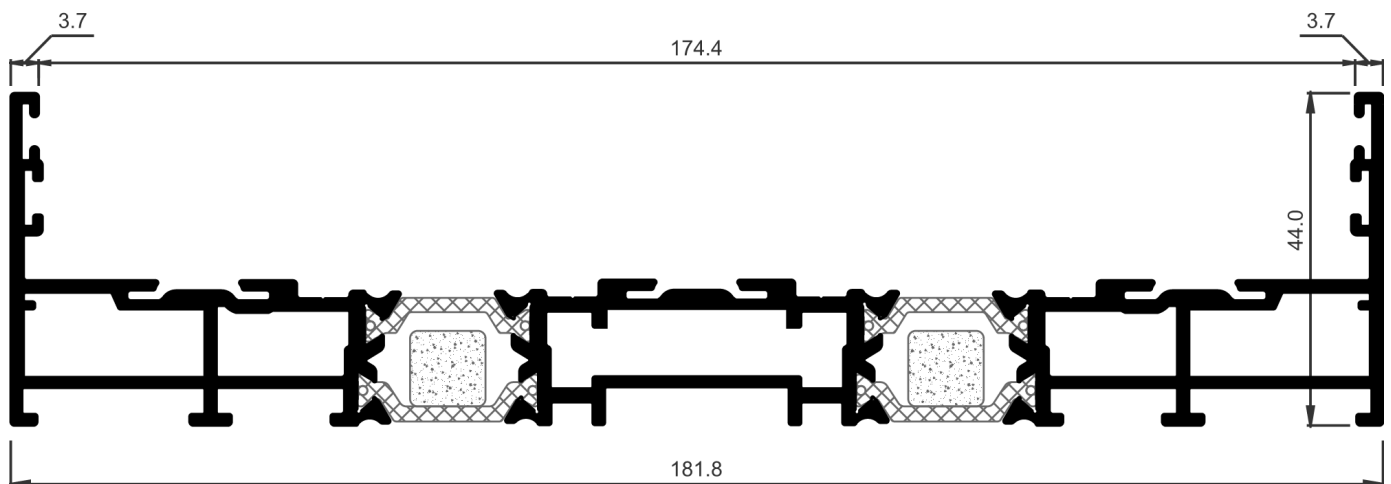

**COR-4391**

<b>Descripción</b> Description	Marco HI tricarril con marco inox. HI three rail frame with stainless steel frame
<b>Peso</b> Weight (g/m)	3019
<b>Superficie</b> Surface (dm <sup>2</sup> /m)	117,25
<b>I<sub>x</sub></b> (cm <sup>4</sup> )	8,17
<b>I<sub>y</sub></b> (cm <sup>4</sup> )	346,82
<b>Escuadra principal</b> Main cleat	248220
<b>Troquel</b> Punch tool	304398
<b>Escuadra secundaria</b> Secondary cleat	248220
<b>Escuadra alineamiento</b> Alignment cleat	960023

**SALIDA DE AGUAS EN MARCOS - SISTEMA CON CANALETA DE RECOGIDA. MARCO EMBUTIDO**

Solución de drenaje recomendada para zonas expuestas

DRAINAGE IN FRAME - SYSTEM WITH PICKUP DUCT. EMBEDDED FRAME

Drainage solution recommended for exposed areas

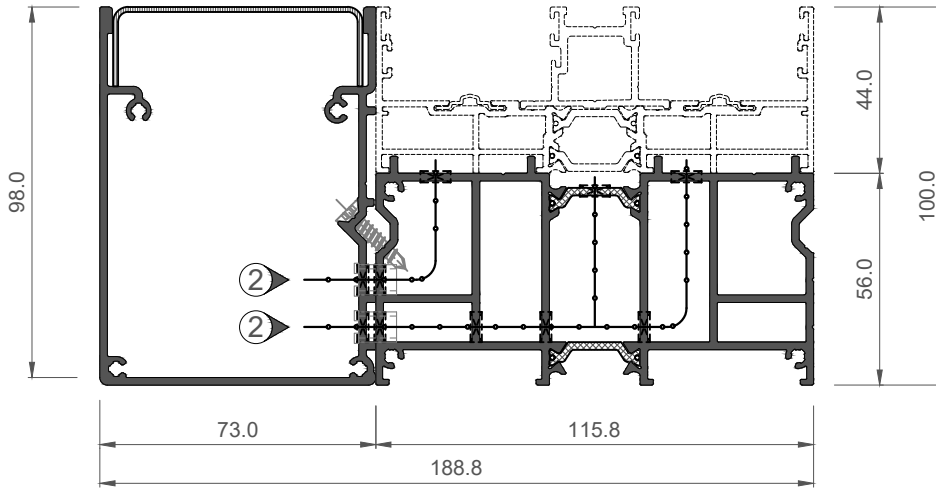

- 2 Salida de aguas hacia canaleta, taladro de Ø8 mm.  
Horizontal inferior: Situar a 120 mm de los extremos, otro a L / 2 y cada 500 mm.  
Water exit to gutter Ø8 mm drill.  
Bottom horizontal: Position 120 mm to the ends, another L / 2 and every 500 mm.

